

2018 Annual Meeting of the
Great Plains-Rocky Mountain Division of the
Association of American Geographers

Short Final Program

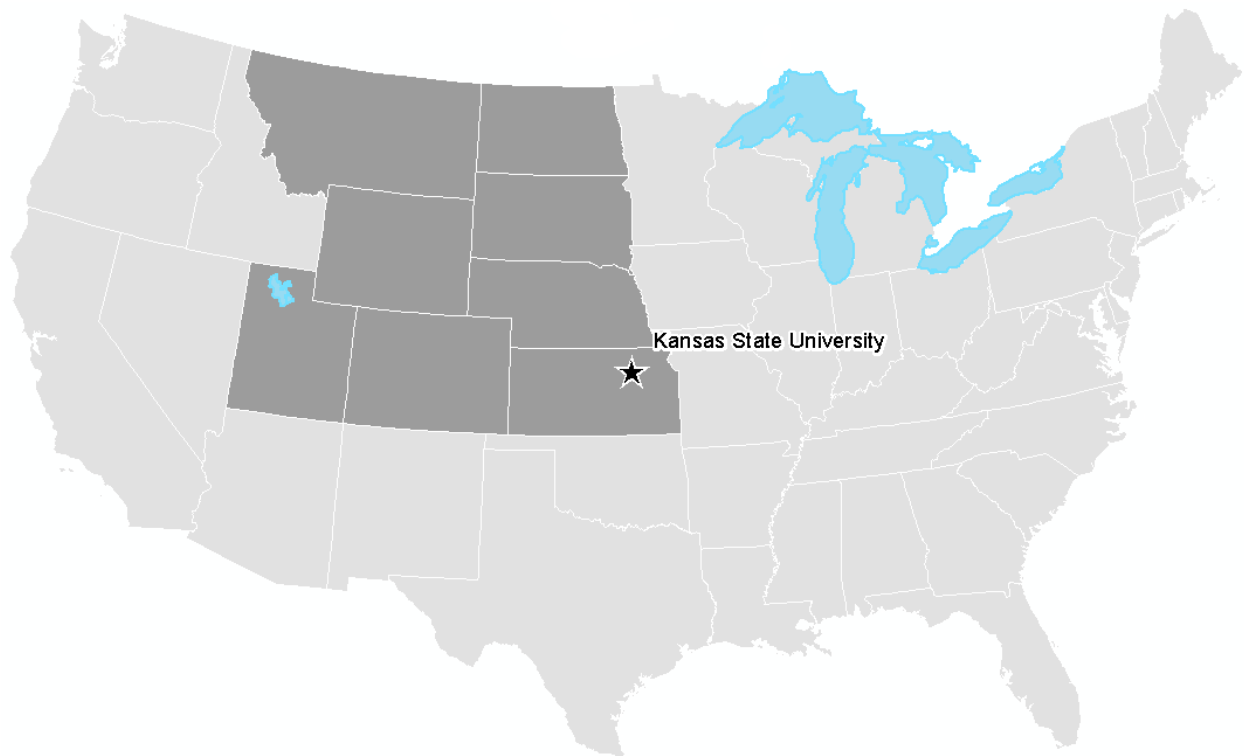

Find more information about the conference and venue at:

<http://www.ksu.edu/gprm2018>

Share news about the GPRM meeting via Twitter using:

#gprm2018

KANSAS STATE
UNIVERSITY | Department of Geography

Conference at a Glance

Friday, October 5 at Seaton Hall or Berney Family Welcome Center

Time	Event
12:30 PM – 1:00 PM	Registration (Department of Geography, 1002 Seaton Hall)
1:00 PM – 4:30 PM	Field Trips and Workshop (gather at Registration Desk to meet trip/workshop leader): <i>Chasing Geography and History along the Kaw River Valley – Dr. Jeffrey Smith</i> <i>The Konza Prairie Biological Station and Kansas Flint Hills – Dr. Kendra McLaughlan</i> <i>Introduction to R Programming for Visualization – Dr. Shawn Hutchinson</i>
6:00 PM – 9:00 PM	Welcome Reception (Berney Family Welcome Center) and Registration
9:00 PM	GPRM Student Social (Venue TBA)

Saturday, October 6 at KSU Student Union

	Flinthills	Cottonwood	Big 12	Room 227
7:30 AM	Registration (1 st Floor, KSU Student Union)			
8:00 AM – 8:50 AM	Opening Plenary (Forum Hall) <i>Welcome: Dr. Charles Martin (Department of Geography, Kansas State University)</i> <i>Keynote: Dr. Timothy Keane (Landscape Architecture and Regional & Community Planning, Kansas State University)</i>			
9:00 AM – 5:20 PM	A5 Poster Session (KSU Ballroom) <i>Poster presenters need to be at their posters from 1:20-1:50 PM</i>			
9:00 AM – 10:40 AM	A1 Maps, Media, and Education	A2 Managing Landscape Use	A3 NSF Tips and Strategies	A4 Water
10:50 AM – 12:30 PM	B1 Plains and Towns	B2 Geographies Place Attachment	B3 Agriculture	B4 Models of Landscape/Landuse
12:30 PM – 1:50 PM	“On Your Own” Lunch			
1:50 PM – 3:30 PM	C1 Spatial Policy	C2 South Asia and SIDS	C3 Physical Geography 1	C4 Encroachment or Opportunity
3:40 PM – 5:20 PM	D1 Cultural Geography	D2 People and Population	D3 Physical Geography 2	
5:30 PM – 6:30 PM				GPRM Business Meeting
5:30 PM – 7:00 PM	GPRM GeoBowl (Teams meet in Big 12 Room no later than 5:30 PM to receive instructions)			
7:00 PM – 9:00 PM	Banquet and Awards Dinner (Main Ballroom) <i>Welcome: Dr. Amit Chakrabarti (Dean, College of Arts & Sciences, Kansas State Univ)</i> <i>Keynote: Dr. David Kaplan (Vice-President, AAG)</i> <i>Awards Presentation: Dr. Arnaud Temme (Kansas State University)</i>			

Field Trips

Meet in Seaton Hall Lobby near Department of Geography Office

Chasing Geography and History along the Kaw River Valley

Host: Jeffrey S. Smith, Kansas State University

Duration: Half Day (1:00 PM – 4:30 PM)

Recommended: Sturdy walking shoes, seasonal jacket, and water bottle

Cost: \$20.00

This field trip will visit communities within the Kansas (Kaw) River valley and examine changes in population and culture over time. Lunch is not included in the trip. Please plan to begin the trip after lunch on your own.

The Konza Prairie Biological Station and Kansas Flint Hills

Host: Kendra McLauchlan, Kansas State University

Duration: Half Day (1:00 PM – 4:30 PM)

Recommended: Sturdy walking shoes, seasonal jacket, long pants, and water bottle

Cost: \$35.00

This field trip will visit the nearby Konza Prairie Biological Station, a NSF-funded Long-term Ecological Research site, for discussion of current research and views of the tallgrass prairie and Kansas Flint Hills. Lunch is not included in the trip. Please plan to begin the trip after lunch on your own.

Introduction to R Programming for Visualization

Host: Shawn Hutchinson, Kansas State University

Duration: Half Day (1:00 PM – 4:30 PM)

Recommended: Be prepared to take notes and bring a USB drive to store data and R scripts used and developed in our session

Cost: Free!

R is a popular and useful language and environment for statistical computing and graphics that has become an increasingly important component of a geographer's research toolkit. In the hands of a skilled researcher, R can be used to perform a broad (and growing) range of analysis, data manipulation, spatial analysis, and visualization tasks. This introductory workshop is designed for those who want to learn how to use R independently with an emphasis on data manipulation and graphing for exploratory data analysis and visualization. Lunch is not included in the workshop. Please plan to begin the session after lunch on your own.

Opening Plenary Keynote

Saturday, October 6 | 8:00 AM– 8:50 AM | Forum Hall



“Rhyming West: Cowboy Poetry Then and Now”

Dr. Timothy Keane

Professor and Director of Research, Scholarship, and Creative Activity
College of Architecture, Planning, and Design
Department of Landscape Architecture and Regional & Community Planning
Kansas State University

Tim Keane is Professor of Landscape Architecture and Distinguished Graduate Faculty in the College of Architecture, Planning, and Design at Kansas State University where he has served since 1984. His research involves the study of rivers, creeks, gullies and erosional/depositional processes. While this all sounds quite pretentious, he attempts to remain pragmatic, half-hand, and on occasion, entertaining. Tim has been attempting to write “cowboy poetry” for thirty years or more. In 2014, 2017, and 2018 Tim was named “Champion” in the Kansas Cowboy Poetry Contest and in 2016 and 2018 he was Reserve Champion at the National Cowboy Poetry Rodeo (NCPR) where he has won multiple events. Keane lives with his wife Sharon and a couple of bird dogs in northwest Wabaunsee County, Kansas.

Dinner and Awards Banquet Keynote

Saturday, October 6 | 7:00 PM – 9:00 PM | Main Ballroom



“Expanding the Community of Geography”

David H. Kaplan

Vice-President, American Association of Geographers
Professor of Geography, Kent State University

Dr. David Kaplan is a Professor of Geography at Kent State University. He has written some 60 peer-reviewed articles and chapters, and has also published *Segregation in Cities, Nested Identities, Boundaries and Place, Human Geography, Urban Geography, Landscapes of the Ethnic Economy, Perthes World Atlas*, the four volume *Nations and Nationalism: A Global Historical Overview, Navigating Ethnicity* and *Scaling Identities*. Dr. Kaplan’s research interests include nationalism, borderlands, ethnic and racial segregation, urban and regional development, housing finance, and sustainable transportation. Dr. Kaplan has directly supervised 48 graduate students and teaches courses on many different aspects of human geography. Dr. Kaplan is the Vice President and upcoming President for the American Association of Geographers, the largest academic geography association in the Americas, and is a Councilor for the American Geographical Society, the United States’ oldest geographical organization. He edits the *Geographical Review*, the flagship journal of the AGS, as well as *National Identities*.

Special Sessions

A3: Tips and Strategies in Writing Effective Proposals for the National Science Foundation (NSF) | Big 12 Room | 9:00 AM – 10:40 AM

Organized by Jacqueline M. Vadjunec (National Science Foundation, Geography and Spatial Sciences)

This outreach session is intended for faculty members, professional geographers, and graduate students who engage in geographic or spatial scientific research and who wish to learn how to prepare effective proposals for NSF. A Program Director from the Geography and Spatial Sciences (GSS) Program at the National Science Foundation (NSF) will discuss research grant opportunities at NSF and highlight ways to improve the quality and competitiveness of a proposal. The session will include details about the review process, including the intellectual merit and broader impacts review criteria. Ample time for Q&A will be provided.

B2: Geographies of Place Attachment | Cottonwood Room | 10:50 AM – 12:30 PM

Organized by Joshua Hagen (Northern State University) and Alexander C. Diener (University of Kansas)

This session encompasses a diverse range of case studies exploring the human propensity to feel connected to place and space. The notion of place attachment captures that proclivity nicely and its role in how people organize their surroundings while making sense of the world and our place in it. These geographies of place attachment can take many forms, ranging from banal acts of everyday life to spectacular assertions of authority.

C2: South Asia and Small Island Developing States (SIDS) | Cottonwood Room | 1:50 PM – 3:30 PM

Organized by Bimal Kanti Paul (Kansas State University) and S.A. Hasnath (Boston University)

This special session focuses on selected contemporary environmental and other emerging problems in South Asia and addresses how countries in the region have been trying to solve these problems on their own - without seeking external assistance. The session also focuses on an issue of Small Island Developing States (SIDS), which is widely seen as an important barrier for development and political instability of these countries.

C4: Encroachment or Opportunity? Geography in a World of Environmental Studies, Global and International Studies, GIScience, Environmental Science, and Sustainability Studies | Room 227 | 1:50 PM – 3:30 PM

Organized by Deborah Thomas (University of North Carolina Charlotte) and Shannon O'Lear (University of Kansas)

With the creation and expansion of interdisciplinary programs, geography must position itself strategically. Departments and/or curriculum in sustainability, such as global studies, international studies, environmental science among others, run the risk of encroaching on geography majors and enrollments or can complement and augment geography degrees. This facilitated workshop will explore opportunities, strategies and challenges to this dilemma.

Papers and Posters

Underlined = Session Chair * = Graduate # = Undergraduate ~~Strikethrough~~ = Withdrawn

A1: Maps, Media, and Education | Flint Hills Room | 9:00 AM – 10:40 AM

- **A1.1. Measuring Place in the News: Using Big Data to Find Over- and Underrepresented Places in Media**
David Parr and Todd Jacobus
Metropolitan State University of Denver
- **A1.2 An Interactive Point Pattern Analysis Web Application and Teaching Exercise**
Jonathan C. Comer (1) and Mathew Haffner (2)
(1) Oklahoma State University, (2) University of Wisconsin – Eau Claire
- **A1.3 Geography with Goudge: Using Weekly Media Maps as a Form of Community Outreach**
Theodore L. Goudge
Northwest Missouri State University
- **A1.4 The Use of Air Navigation Maps and Related Resources in Geographic Education**
Richard Lisichenko and Thomas Schafer
Fort Hays State University
- **A1.5 Patterns in the Locations of U.S. Mass Shootings**
Avonlea Keenen*
Oklahoma State University

A2: Managing Landscape Use | Cottonwood Room | 9:00 AM – 10:40 PM

- **A2.1 Indigenous Territorial Jurisdictions and Forest Conservation in Central America**
Peter Herlihy, M.L. Fahrenbruch, and T.A. Tappan
University of Kansas
- **A2.2 Biophysical and Economic Impacts of Farmer Managed Natural Regeneration in the Province of Bam in Burkina Faso**
Brice B. Zoungrana*
South Dakota State University
- **A2.3 Floods, Droughts, Oil Spills, and Citizen Engagement: A Longitudinal Study of Life on the Yellowstone River**
Susan J. Gilbertz (1), Damon M. Hall (2), and Christopher Craig (1)
(1) Montana State University Billings, (2) University of Missouri
- **A2.4 Standing Rock: Understanding Patterns and Impacts of Land Allotment**
Stephen L. Egbert (1), Joshua Meisel (1, 2), and Joseph Paul Brewer II (1)
(1) University of Kansas, (2) Haskell Indian Nations University
- **A2.5 A Socio-Hydrology Profile Methodology: Including Human and Social Attributes**
Jean Eichhorst
University of Wisconsin-Eau Claire

A3: NSF Tips and Strategies | Big 12 Room | 9:00 AM – 10:40 AM

Organized by Jacqueline M. Vadjunec (National Science Foundation, Geography and Spatial Sciences)

- **A3.1 Tips and Strategies in Writing Effective Proposals for the National Science Foundation**
Jacqueline M. Vadjunec
National Science Foundation, Geography and Spatial Sciences

A4: Water | Room 227 | 9:00 AM – 10:40 AM

- **A4.1 “In Budyko We Trust”: Application of the Budyko Framework for Streamflow Partitioning in a Glaciated Prairie Landscape**
Paul Todhunter (1), Courtney Jackson (2), and Taufique Mahmood (2)
(1) University of North Dakota, (2) Pennsylvania State University
- **A4.2 FOSSFlood: Free and Open Source Software for Harnessing the Potential of the National Water Model**
James Coll* (1) and Mike Johnson (2)
(1) University of Kansas, (2) University of California, Santa Barbara
- **A4.3 Lake Storage Variation on the Endorheic Tibetan Plateau and its Attribution to Climate Change Since the New Millennium**
Fanfang Yao* (1), Jida Wang (1), Kehan Yang (2), Chao Wang (3), Blake Walter (1), and Jean-François Crétaux (4)
(1) Kansas State University, (2) University of Colorado Boulder, (3) University of Puerto Rico, (4) Laboratoire d’Études en Géophysique et Océanographie Spatiales (LEGOS)
- **A4.4 Global Assessment of Surface Water Abundance in Lakes and Reservoirs**
Meng Ding* and Jida Wang
Kansas State University
- **A4.5 Dioxins and Fish Consumption on the Lower Ohio River**
John Paul Henry*
University of Kansas

A5 Posters | KSU Ballroom | 9:00 AM – 5:20 PM

- **A5.1 The Impacts of Public-Private School Choice on Public Schools in the St. Louis Area**
Tessa Cook*
Oklahoma State University
- **A5.2 “Getting that Jellyfish Crunch”: Sequential Exploitation, Cannonball Jellyfish, and the Global Jellyfish Market**
Matthew L. Fahrenbruch*
University of Kansas
- **A5.3 Assessment of Regeneration Time of an Evergreen Forest After Wildfire Using LANDSAT Images**
Fatema Tuz Johra Nourin* and Chen Xu
University of Wyoming
- **A5.4 The Effects of Distance on the Composition of U.S. State Legislatures**
Jesse R. Andrews*
Oklahoma State University
- **A5.5 The Electricity Sector Evolution in Brazil: The Emergence of BioElectricity**
Helder Martins*
Federal University of Santa Catarina (Brazil)
- **A5.6 Climatic and Environmental Factors Influencing Parcel-Scale Woody Plant Encroachment in Cimarron County, Oklahoma**
Austin Boardman* and Jacqueline M. Vadjunec
Oklahoma State University
- **A5.7 Quaternary Landscape Reconstruction Using Bioclimatic Envelopes and Pollen Based Modelling Approaches in Southern Wyoming**
Thomas Koenig*
University of Wyoming

- **A5.8 Using Structure-from-Motion Photogrammetry and Erosion Pins to Quantify Controls on Bedrock Erosion and Sediment Transport in a Heterogeneously Layered Landscape, Flint Hills, KS**
Abbey L. Marcotte* and Abigail L. Langston
Kansas State University
- **A5.9 Analyzing Tornado Frequency and Regional Climate Change Relationships in Kansas CE 1950-2016**
Michael S. Molloy* and Bimal Kanti Paul
Kansas State University
- **A5.10 A Geography of Advertising in Early Automobile Route Guides**
John T. Bauer and Claire M. Christner
University of Nebraska Kearney
- **A5.11 Identifying Food Deserts in Rural North Dakota: A GIS-Based Analysis of Food Accessibility**
Phoebe Eichhorst#, Zachary Seeger, and Enru Wang
University of North Dakota
- **A5.12 Quantifying the Effects of Sediment Flux and Water Discharge on Lateral Bedrock Erosion Using Flume Experiments**
Ricardo Gonzalez# and Abigail L. Langston
Kansas State University
- **A5.13 Patterns of Cottonwood Forest Change Along the South Platte River, Logan County, Colorado, 1979-2016**
Haley Hampstead# (1), Gabrielle Katz (1), and Jessica Salo (2)
(1) Metropolitan State University of Denver, (2) University of Northern Colorado
- **A5.14 Changes in Weather by Elevation in a Colorado Mountain Environment During a Winter Storm Event**
Jana MacInnis#, Kimberly Clough, Destarte "Conagher" Haun
University of Colorado Colorado Springs
- **A5.15 Libya's Seismic History: From Roman Records to Modern News**
Somaia Suwihli* and Thomas R. Paradise
University of Arkansas
- ~~**A5.16 The Diverse Faces of American Agriculture: Gendered and Racial Representations of Farmers and Ranchers in the Southern Great Plains**~~
~~Maria Ramirez Saenz, Fernanda Ramirez Saenz*, Jacqueline M. Vadjunec, and Todd Fagin~~
~~Oklahoma State University~~
- **A5.17 The Contemporary Scottish Gaelic Linguistic and Cultural Landscape**
John Paul Rogers*
Kansas State University
- **A5.18 The Importance of Geographic Realism in Genre Fiction: How Place and Landscape in Robin Hobb's *Assassin's Quest* Produce Subversive Social Critique**
C.A. Shropshire*
Oklahoma State University
- **A5.19 The Connections of Grassland Conversion in the Midwest**
Lucas Porter* and Darrell Napton
South Dakota State University
- **A5.20 The Interconnected System of Geology, Soils and Land Use around Álora, Spain**
Marte M. Stoorvogel*
Wageningen University (The Netherlands)
- **A5.21 Locating Suitable Locations to Measure Snow Avalanche Geomorphic Impacts**
Michael Stumpff* and Arnaud J. Temme
Kansas State University

- **A5.22 Land Use and Land Cover Changes in the 'Ghost Villages' of Uttarakhand, India**
Komal Preet Kaur* and Marcellus Caldas
Kansas State University
- **A5.23 Assessing Impacts of Grass on Vertical Accuracy of Digital Surface Models Derived from Unmanned Aerial Systems**
Amanda F. Thomas*
Oklahoma State University
- **A5.24 Time Series Analysis of Phenometrics and Long-Term Grassland Trends across the Great Plains Ecoregion using Moderate Resolution Satellite Imagery**
J.M. Shawn Hutchinson and Hilda Onuoha
Kansas State University
- **A5.25 Where are Dams and Reservoirs, and How Do They Affect Surface Water Budget?**
Jida Wang, Blake A. Walter, and Fangfang Yao
Kansas State University
- ~~**A5.26 Maternal Mortality and Population Growth in 19th Century Britain**~~
~~Andrew Smith#~~
~~Brigham Young University~~
- **A5.27 The Sinking Island of Isle de Jean Charles: How Climate Change, Oil Development, and Severe Weather are Impacting the Native American Community**
Clayton Blodgett and Kane Wolkey#
University of Missouri
- **A5.28 Mapping Imperialism: Integrating Geography into History Lessons**
Jessica Hunt# and Dawn M. Drake
Missouri Western State University
- **A5.29 The Benefits of GIS to Public Works Departments: The Case of St. Joseph, Missouri**
Cheyenne Curley# and Dawn M. Drake
Missouri Western State University
- **A5.30 Using GIS to Overcome Language Barriers in Healthcare**
Kim Leach# and Dawn M. Drake
Missouri Western State University
- **A5.31 Spatial Examination of Nebraska's Pioneer and Heritage Farms**
Natasha Winfield# and Jason Combs
University of Nebraska-Kearney

B1: Plains and Towns | Flint Hills Room | 10:50 AM – 12:30 PM

- **B1.1 Changes in the Landscape of a Northern Plains Town: Antler, North Dakota (1900 to 2018)**
W.A. Wetherholt (1) and G.S. Vandeberg (2)
(1) Frostburg State University, (2) University of North Dakota
- **B1.2 Deconstructing the Rural Kansas Stereotype: The Story of Bradford, Wabaunsee County, a Lost Biracial Community, 1890-1941**
Karl F. Bauer
University of North Dakota
- **B1.3 The Historic Preservation of Northern Rocky Mountain Ghost Towns**
Krista Evans
Missouri State University
- **B1.4 Pipelines, Protectors, and a Sense of Place: Media Representations of #NoDAPL**
Katie Grote*
University of Kansas

- **B1.5 A Cultural Geography of Visualizing Spatial Attributes of Human Trafficking in the American Great Plains**
Rebecca Buller
University of Nebraska - Lincoln

B2: Geographies of Place Attachment | Cottonwood Room | 10:50 AM – 12:30 PM
Organized by Joshua Hagen (Northern State University) and Alexander C. Diener (University of Kansas)

- **B2.1 Making Places and Spaces of Memory in Nazi Germany: Semiotics, Performativity, and Affect**
Joshua Hagen
Northern State University
- **B2.2 Exogenous place attachment and Amazonian conservation.**
Stephen Cameron*
University of Kansas
- **B2.3 “Tied To The Land”: Pipelines and Place Attachment**
Christina Dando
University of Nebraska Omaha
- **B2.4 Attachment to Vanishing Places**
Jeffrey Smith
Kansas State University
- **B2.5 Theorizing Multi-Scalar Territorialization in Central Asia: Russians in Kazakhstan’s Northern Borderland**
Alexander Diener
University of Kansas

B3: Agriculture | Big 12 Room | 10:50 AM – 12:30 PM

- **B3.1 Exploring the Impacts of Agricultural Landscape Diversity on Yields in the U.S. Using Bayesian Spatiotemporal Modeling**
Katherine S. Nelson (1) and Emily K. Burchfield (2)
(1) Kansas State University, (2) Utah State University
- **B3.2 Using Remote Sensing to Detect Changes in Vegetated and Riparian Buffer in Agricultural Areas of Nebraska: Preliminary Results**
Alex R. Mohr*
University of Nebraska Omaha
- **B3.3 Dynamics of Soybeans and Cattle Production in Brazil**
Rebecca Lima Albuquerque Maranhão* (1), Osmar Abílio de Carvalho Júnior (2), Potira Meirelles Hermuche (2), Roberto Arnaldo Trancoso Gomes (2), Concepta McManus (2), and Renato Guimaraes (2)
(1) Kansas State University, (2) University of Brasilia (Brazil)
- **B3.4 Analysis of Dairy Cow Populations and Land Use in the Kansas City Milkshed**
Dawn M. Drake
Missouri Western State University
- **B3.5 A Hidden Past: The Historical Geography of Agricultural Drainage in Iowa**
Jakob Hanschu#
Kansas State University

B4: Models of Landscape and Landuse | Room 227 | 10:50 AM – 12:30 PM

- **B4.1 Participatory Mapping the Public Perceptions of Browns Canyon National Monument, Colorado**
John Harner (1), Lee Cerveny (2), and Rebeccas Gronewold (1)
(1) University of Colorado Colorado Springs, (2) U.S. Forest Service
- **B4.2 Assessing the Quantitative and Qualitative Differences between 3D Models Produced from LiDAR and Structure from Motion**
Matthew Moebes* and Clayton Blodgett
University of Missouri
- **B4.3 Open (Paper Withdrawn)**
- **B4.4 The Compounding Threat to Brazilian Cerrado Biodiversity: Exploring Land and Climate Change Impacts on Amphibian Habitats**
Marcellus Caldas (1), Gabriel Granco (1), and Paulo de Marco Jr. (2)
(1) Kansas State University, (2) Federal University of Goiás
- **B4.5 Geotagging and Geobragging**
J. Stubbendeck#
University of Nebraska Lincoln

C1: Spatial Policy | Flint Hills Room | 1:50 PM – 3:30 PM

- **C1.1 How Does Place-based Culture Influence on Pro-Environmental Policy Support? An Examination using Agent-based Simulations**
Gabriel Granco, Marcellus Caldas, and Matthew Sanderson
Kansas State University
- **C1.2 Indus the Blue Gold: - Rethinking on the Transboundary Water Distribution Between India and Pakistan**
Puja Jana*
Oklahoma State University
- **C1.3 A Preliminary Examination of Wildfire Evacuation Zoning: Evidence from the Vineyard Fire and the Carr Fire**
Dapeng Li
South Dakota State University
- **C1.4 For the Greater Good: How Flood Control and Stream Management Became a Federal Concern**
Michael A. Urban
University of Missouri
- **C1.5 Public-Private Partnerships with Public Transit, Local Government Agencies, and Ridesourcing in Denver, CO**
Sylvia Arriaga Brady*
University of Denver

C2: South Asia and Small Developing Islands (SIDS) | Cottonwood Room | 1:50 PM – 3:30 PM

Organized by Bimal Kanti Paul (Kansas State University) and S.A. Hasnath (Boston University)

- **C2.1 How Many Monolingual Countries Are There? Language Diversity in Small Island Developing States (SIDS)**
Bimal Kanti Paul
Kansas State University

- **C2.2 Large Development Projects in Shaping Land Use and Livelihood: A Case Study of the Padma Multipurpose Bridge Project, Bangladesh**
Jawata Afnan Saba* (1), Abu Suphiyan Shekh (2), and Manjur Morshed (3)
(1) South Dakota State University, (2) Jahangirnagar University, (3) Khulna University of Engineering and Technology
- **C2.3 Determinants of Human Migration in the Climate Change Affected Indian Sundarbans**
Subarna Chatterjee*, Bimal Kanti Paul, and Audrey Joslin
Kansas State University
- **C2.4 Deteriorating Groundwater Quality Causing Health Hazards in Selected Villages of Gautam Budh Nagar District, Uttar Pradesh, India**
V.K. Boken (1), K. Lal (2), I Mukerjee (2), R.K. Yadav (3), and M. Singh (2)
(1) University of Nebraska-Kearney, (2) Indian Agricultural Research Institute, (3) Center for Soil Salinity Research Institute (India)
- **C2.5 Kerala Floods: Should India Change its Foreign Aid Policy?**
Avantika Ramekar* and Bimal Kanti Paul
Kansas State University

C3: Physical Geography 1 | Big 12 Room | 1:50 PM – 3:30 PM

- **C3.1 Two Arguments in Favor of Characterizing Additional Proglacial Soil Chronosequences**
Arnaud J. Temme
Kansas State University
- **C3.2 Dynamics of Lodgepole Pine Forests in Fire-Driven Landscapes: Past, Present and Future**
Barrie Chileen* (1), Kendra K. McLaughlan (1), and Philip Higuera (2)
(1) Kansas State University, (2) University of Montana
- **C3.3 Spatiotemporal Patterns of Human-Induced Landscape Change in a German Agricultural Landscape**
W. Marijn van der Meij* (1, 2), Arnaud J.A.M. Temme (3, 4), and M. Sommer (2)
(1) Wageningen University (Netherlands), (2) Leibniz Centre for Agricultural Landscape Research (ZALF) (Germany), (3) Kansas State University, (4) University of Colorado Boulder
- **C3.4 Assessing the influence of parameters for agricultural flood loss estimation in the Middle Cedar River Watershed, Iowa**
Md Abu Sayeed Marroof*
Kansas State University

C4: Encroachment or Opportunity | Room 227 | 1:50 PM – 3:30 PM

Organized by Deborah Thomas (University of North Carolina Charlotte) and Shannon O’Lear (University of Kansas)

- **C4.1 Encroachment or Opportunity? Geography in a World of Environmental Studies, Global and International Studies, GIScience, Environmental Science, and Sustainability Studies**
Deb Thomas
University of North Carolina Charlotte

D1: Cultural Geography | Flint Hills Room | 3:40 PM – 5:20 PM

- **D1.1 An Analysis of Advertising Revenue in Early Automobile Route Guides**
John T. Bauer
University of Nebraska Kearney

- **D1.2 New Colossus, New Nationalisms? Affective-Discursive Practices and The National Body of “Lady Liberty”**
James E. Baker*
University of Nebraska Lincoln
- **D1.3 Becoming Laura: Performing Gender at Little House Tourist Sites**
Kimberly Johnson Maier*
Oklahoma State University
- **D1.4 Mate Between Mates: The Evolving Social Relations of Yerba Mate Consumption**
Adam S. Dohrenwend*
University of Kansas
- **D1.5 Geographies of Opera in Communist Slovakia**
Brett R. Chloupek
Northwest Missouri State University

D2: People and Population | Cottonwood Room | 3:40 PM – 5:20 PM

- **D2.1 David Rankin: America's Greatest Farmer**
Jason Combs
University of Nebraska Kearney
- **D2.2 Neo-Isolationism in the U.S. Presidential Election of 2016**
J.C. Archer (1), F.M. Davidson (2), E.H. Fouberg (3), F.M. Shelley (4), and R.H. Watrel (5)
(1) University of Nebraska Lincoln, (2) University of Arkansas, (3) Northern State University, (4) University of Oklahoma, (5) South Dakota State University
- **D2.3 The Electoral Geography of Iowa Territory and Early Iowa Statehood**
Robert Shepard
University of Iowa
- **D2.4 Rural Depopulation and the Resurgence of Six-Man Football in Nebraska**
Andrew Husa*
University of Nebraska Lincoln
- **D2.5 Chain Migration as a Factor in Migrants’ Income – a Case Study of the Informal Recycling Sector in Beijing, China**
Jia Feng
Washburn University

D3: Physical Geography 2 | Big 12 Room | 3:40 PM – 5:20 PM

- **D3.1 Parameterization of the Prospect Leaf Reflectance Model for Tallgrass Prairie**
Douglas G. Goodin
Kansas State University
- **D3.2 Predicting and Estimating Land Cover Mapping at Bento Rodrigues Dam Disaster Area using Machine Learning and Landsat Images**
Dong Luo*, Marcellus Caldas, and Douglas G. Goodin
Kansas State University
- **D3.3 Contrasting Effects of Dams on River Morphology and Sand Transport in the Colorado River Basin**
Erich R. Mueller (1), David J. Topping (2), and Paul E. Grams (2)
(1) University of Wyoming, (2) U.S. Geological Survey
- **D3.4 Use of Oklahoma’s Mesonet and Severe Environmental Events**
Steve Stadler (1) and Chris Fiebrich (2)
(1) Oklahoma State University, (2) The Oklahoma Mesonet

KSU Student Union – Ground Floor – Forum Hall

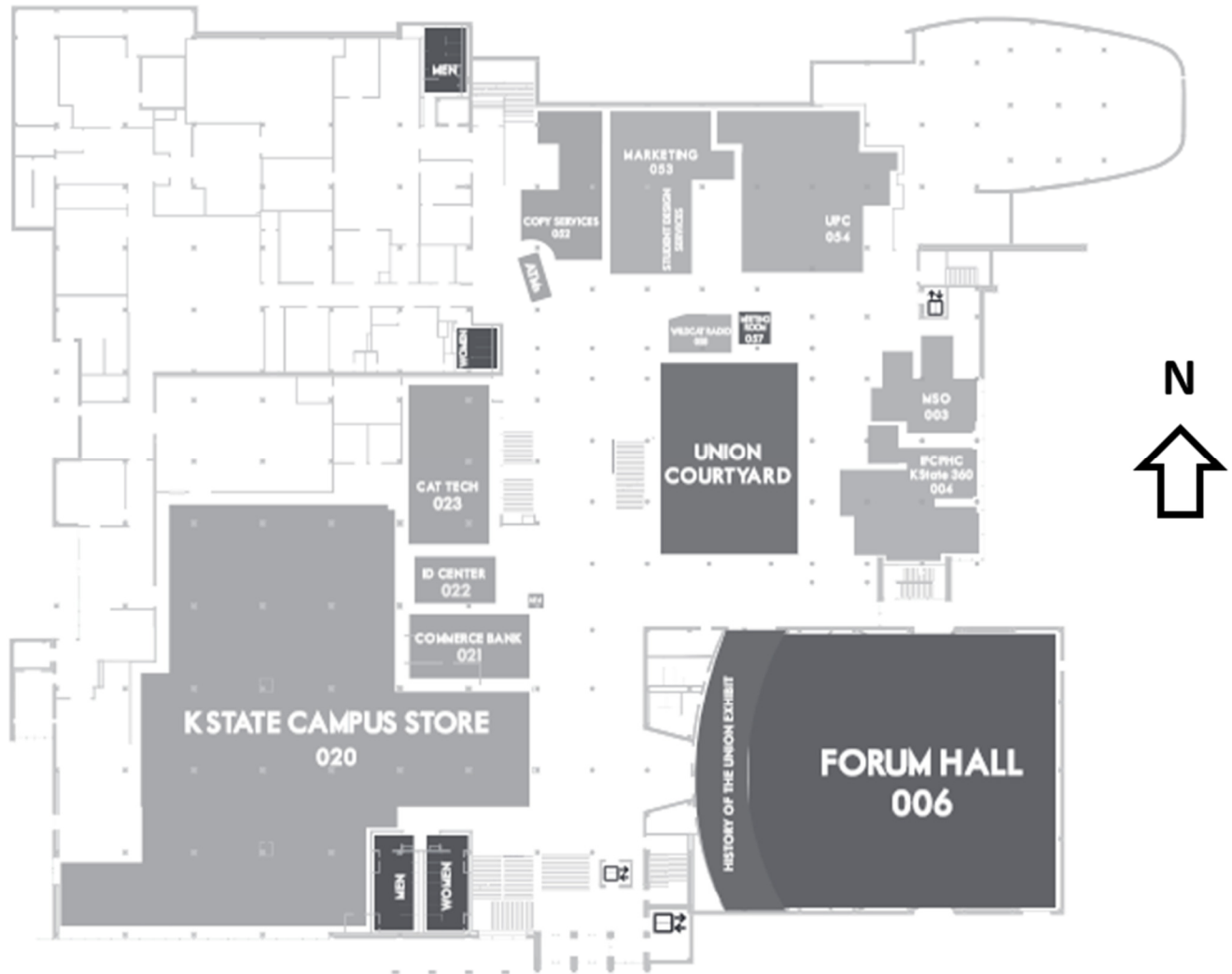

Access from Parking Garage and Holiday Inn Manhattan at the Campus

Wireless Internet – Complimentary wireless access is available throughout the KSU Student Union. You're your computer or mobile device, please choose the network **KSU Guest**. No password is needed.

KSU Student Union – First Floor – Food Service

To Seaton Hall and Department of Geography for Field Trips/Workshop

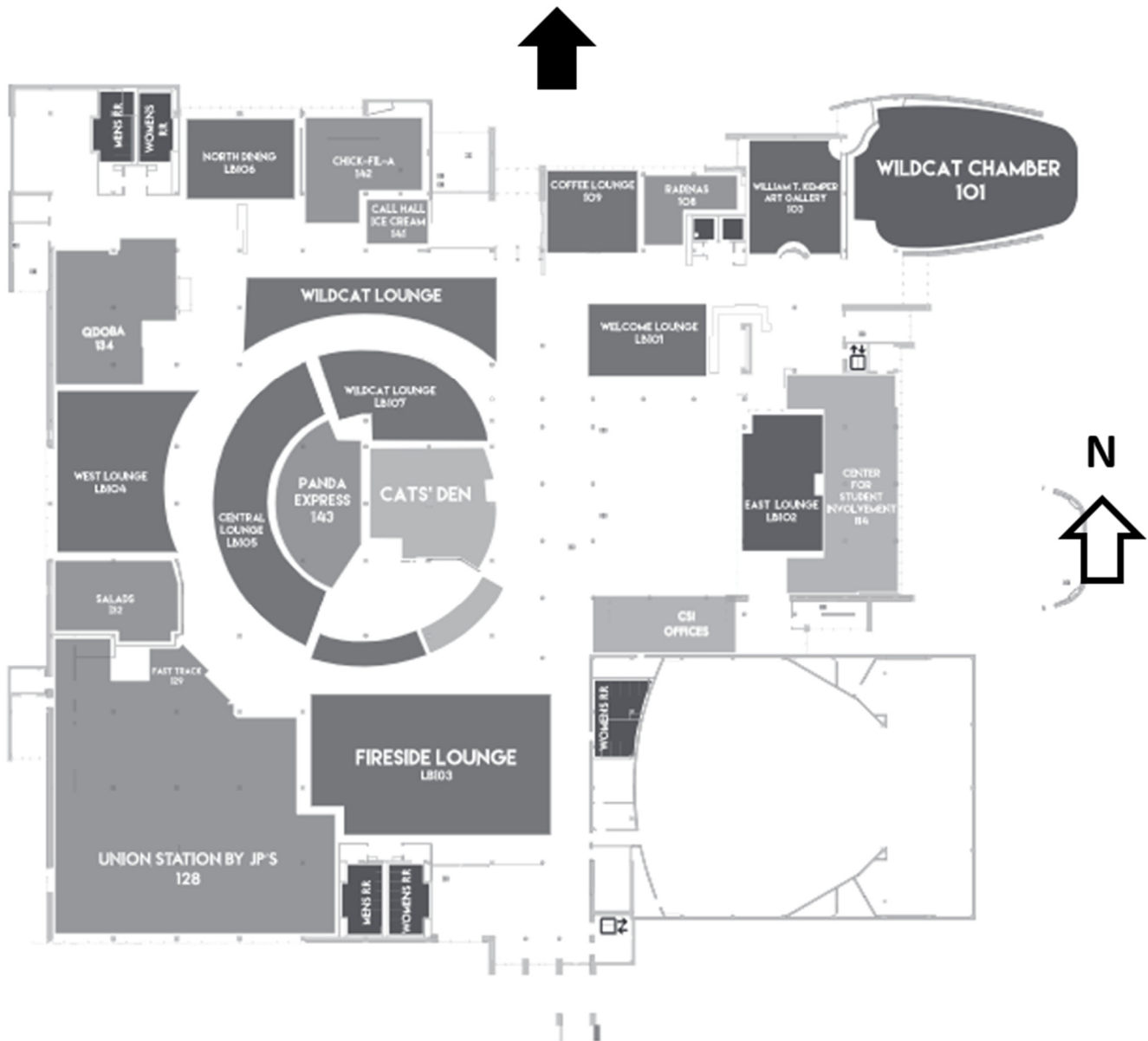

Wireless Internet – Complimentary wireless access is available throughout the KSU Student Union. You're your computer or mobile device, please choose the network **KSU Guest**. No password is needed.

Food Service – We anticipate many of the dining options located in the KSU Student Union to be open during the conference. Restaurants include Chik-fil-A, Panda Express, Union Station by JP's, and Subway (basement). Aggieville, Manhattan's historical college district, also has a variety of food options and is just a short walk from the KSU Student Union. The Cat's Den, a "quick shop" style store, will also be open during the conference.

Registration – The registration desk on Saturday will be located on the First Floor in the vicinity of the Wildcat Lounge.

KSU Student Union – 2nd Floor – Papers, Poster, and Banquet



Conference Rooms – With the exception of the Opening Plenary, all paper and poster sessions will be held in rooms located on the Second Floor of the KSU Student Union. This will also be the location of the Awards Banquet on Saturday evening.

Wireless Internet – Complimentary wireless access is available throughout the KSU Student Union. You're your computer or mobile device, please choose the network **KSU Guest**. No password is needed.