



# College of Veterinary Medicine

2020 Fall Update with the President and Provost

**K-STATE**  
**2025**

**KANSAS STATE**  
UNIVERSITY

## CVM Research Expenditures FY16–20

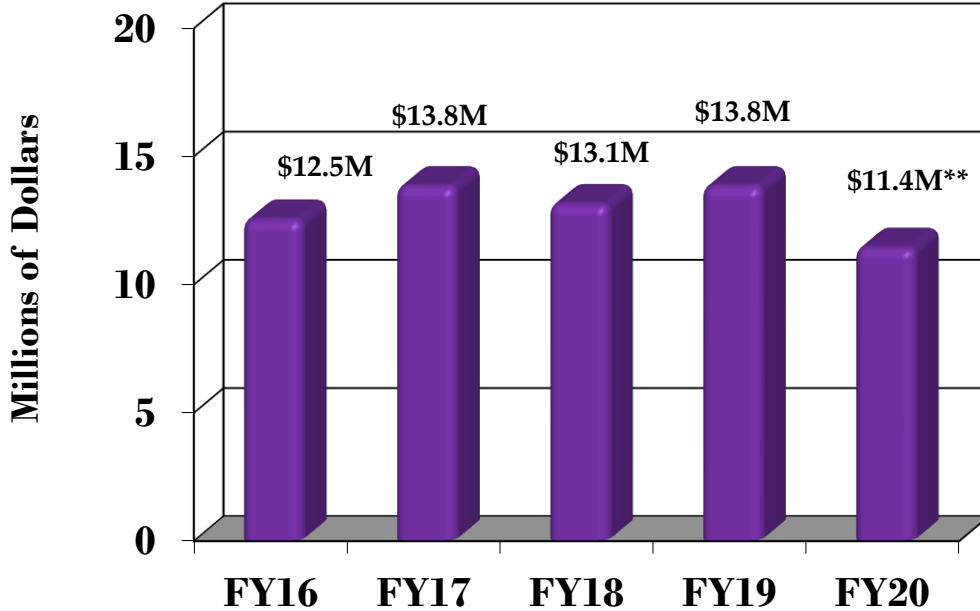

\*\* COVID-19 limited '20 expenditures

### FY ' 20 Awards

- 286 Submitted/151 Funded
- Requested - \$99,891,744
- Funded - \$17,837,791M
  - 2025 Goal = \$17.6M
  - COBRE - \$11.3M/5 years

- **PhD:** 48 students
  - **DVM-PhD:** 9 students (2025 goal = 7)
- **MS:** 75 students
  - **DVM-MS:** 9 students
  - **Olathe:** 19 VBS students (2025 goal = 7)
- **MPH:** 77 students (55 CVM)
  - **Infectious Disease/Zoonosis:** 45 students
  - **DVM-MPH:** 20 students
  - **PH Certificate:** 10 students (5 DVM students)

## **New Programs:**

- **Ag Biosecurity Grad Certificate:** 4 students
- **A&P Non-Thesis MS:** 25 students
- **MPH program - CEPH approval to deliver curriculum online**

# USDA APHIS NBAF Scientist Training Program



**NTSP Fellows:** 8 students

2 DVM/PhD, 2 PhD, 2 MS

\$1.85M USDA-APHIS



Katie Schuck '18



Victoria Ayers '18



Chester McDowell '18



Laura Constance '18



Christian Young '18



Jerusha Matthews '19



Michelle Zajac '20



Konner Cool '21

# Professional Education

Tuition	Educational Debt	
	2019	2020
KS (\$98K)	\$ 128,348	\$ 122,543
At-large (\$215K)	\$ 256,778	\$ 254,303
K-State Average	\$ 212,305	\$195,226
US Average	\$199,148	\$204,675



## Class of 2020

- Employment Rate = 99%
- NAVLE Pass Rate = 97% (NA = 95%)
- 2020 AVMA unemployment rate = 0.7%

Employment Type (non-internship)	Class of 2019 Starting Salary	Class of 2020 Starting Salary	US Average
Large animal predominant	\$ 65,000	\$74,614	\$ 83,978
Mixed practice	\$ 67,555	\$ 75,556	\$ 81,003
Small animal practice	\$ 72,857	\$ 93,384	\$ 95,922
K-State graduate salary	\$ 79,189	\$ 88,149	\$ 92,796

# Areas support by rural scholarship (VTPRK)

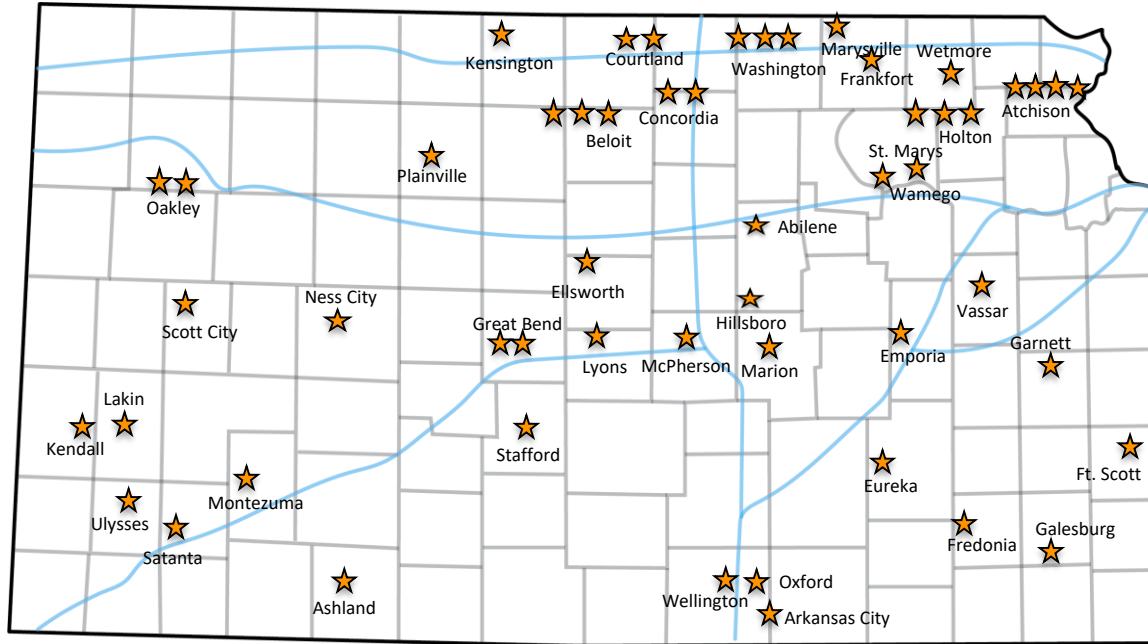

## KS Rural Veterinary Taskforce

- Evaluating veterinary needs, regions of shortfall
- Representatives from KDA, KFB, KLA, ASI, KVMA, CVM
- Cattle Census
- Veterinary Practice Census
- Evaluation of veterinary turnover
- Survey of KFB membership needs
- IMPLAN Economic Impact Data

- 76 recipients
- 97% fulfilled(ing) 4 yrs

Beyond 4 years: 94% are still practicing in a qualifying county.  
77% remain in the practice of origin.

## Veterinary Diagnostic Laboratory COVID-19 Testing

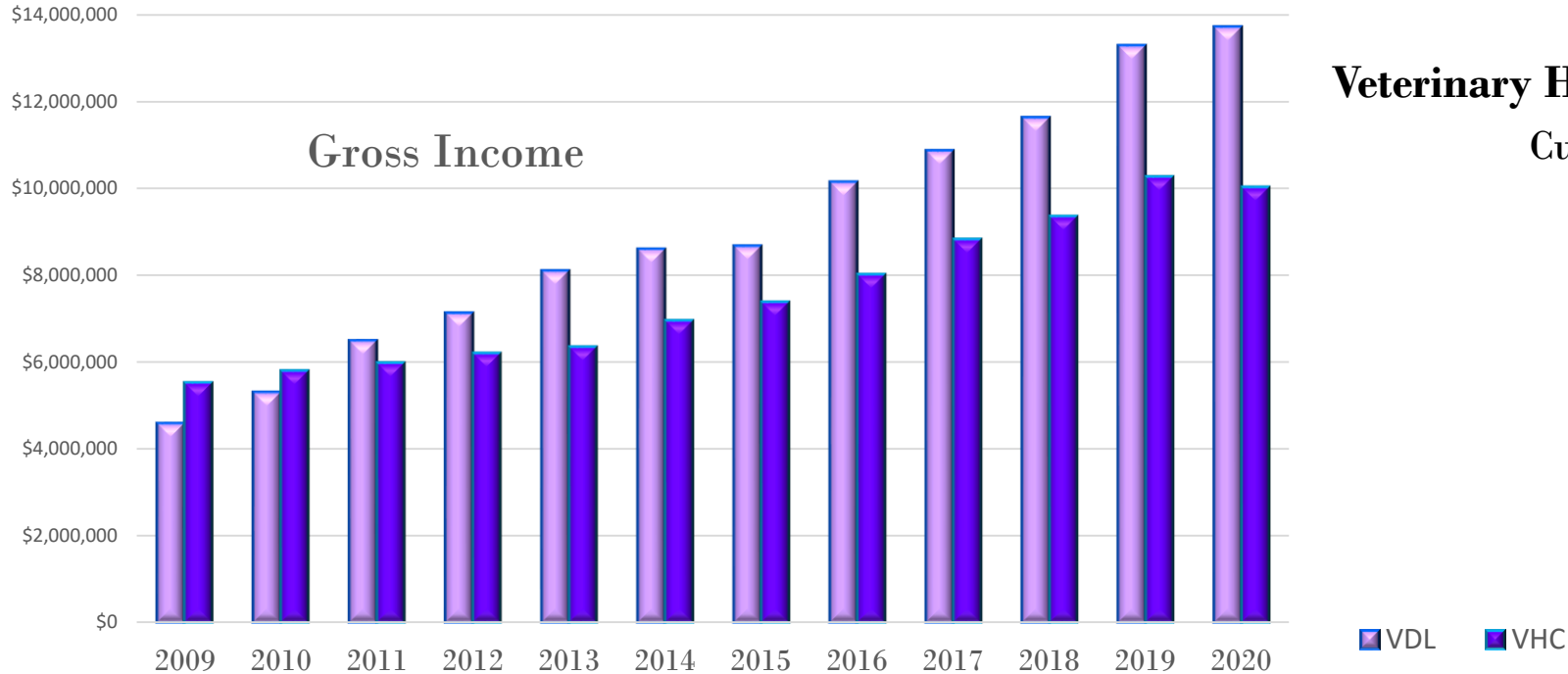

**Veterinary Health Center**  
Curbside service

## Promotions

Associate Professor with Tenure

Jeffrey Comer, Emily Reppert, Victoriya Volkova

Clinical Professor

Neala Boyer, Brad Crauer, Justin Thomason

Professor

Amy Rankin, Dana Vanlandingham

## Professorships (n=12)\*

Newly Awarded: Dr. Mike Sanderson, W.S. and E.C. Jones Departmental Chair of Clinical Epidemiology

## Research Awards

Mike Sanderson, Zoetis Research Award for Excellence in Research

Stephen Higgs, Harry Hoogstraal Medal for Outstanding Achievement in Medical Entomology

David Poole, Iman Research Award

Juergen Richt, National AAVMC Research Excellence Award

Juergen Richt, Fellow of the American Association for the Advancement of Science (AAAS)

Juergen Richt, Agricultural Research Service Midwest Area Award for Excellence in Technology Transfer

Butch KuKanich, David Rankin, Kate KuKanich: 2019 Dechra Analgesia Research Award

## Teaching Awards

Thomas Schermerhorn, Zoetis Distinguished Veterinary Teaching Award

David Poole, Kansas State University's 2019-2020 Coffman Chair for University Distinguished Teaching Scholars

## Service Awards

Dr. Chuck Dodd, KVMA Service Award

Susan Nelson, 2020 William and Deanna Pritchard Veterinary Service & Outreach Award



## 2019

Testing Center - 581 sf

MRI 3.0T - 981 sf

Toxicology Laboratory – 1,000 sf

Clinical Skills Laboratory - 3,600 sf

Fitness Room - 400 sf

## 2020

Enclosed Equine Performance Testing Center

Atrium/Auditorium – 1,800 sf/6,400 sf

Livestock services – 7,500 sf

Primary care center – 4,200 sf

Retail space – 500 sf

Disaster Response/Community Outreach Vehicle

# Livestock Services – Built in 1978



# New Livestock Services









 **MERCK**  
Animal Health



# Auditorium between the buildings

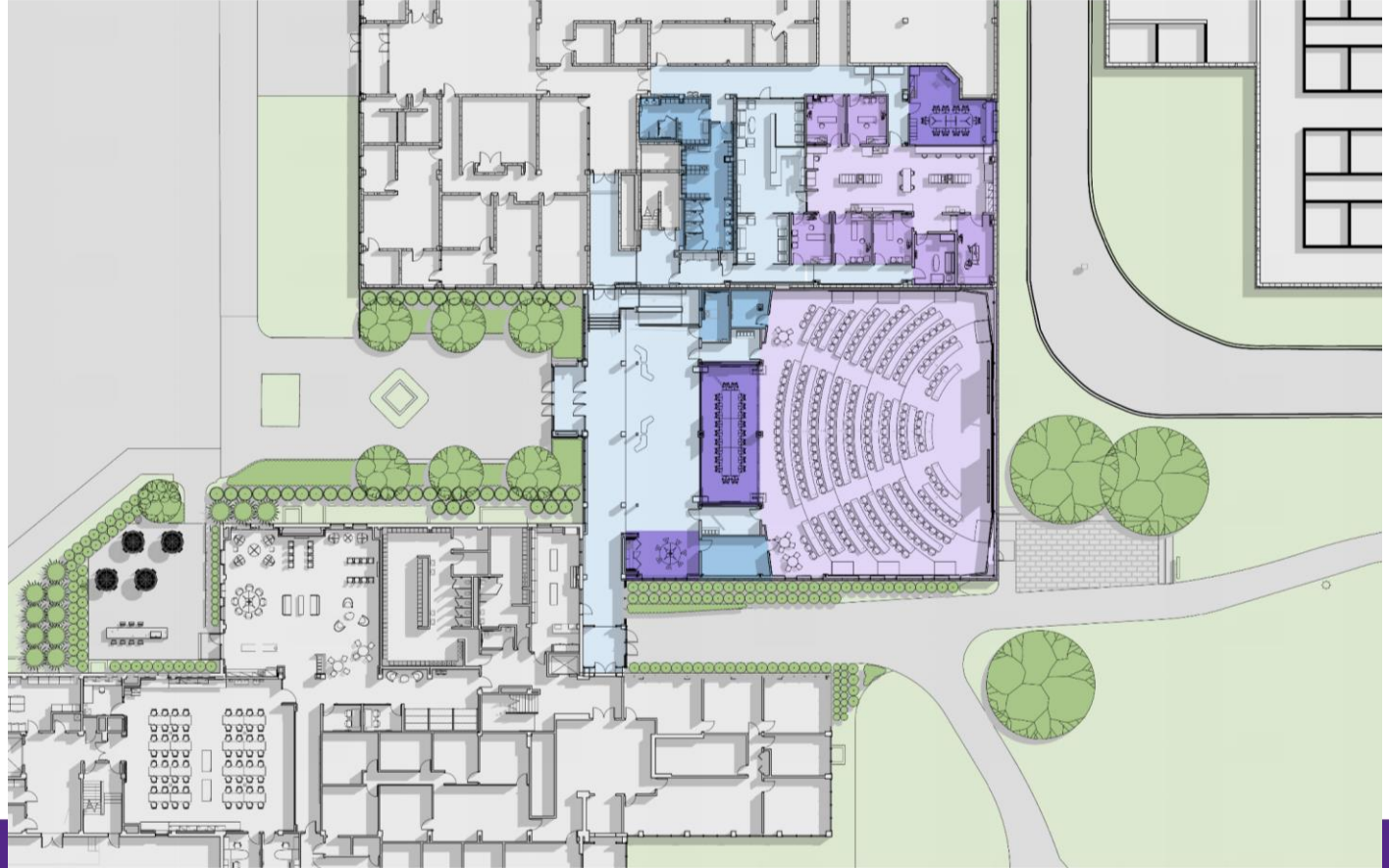















Boehringer  
Ingelheim

# Hill's Pet Health and Nutrition Center

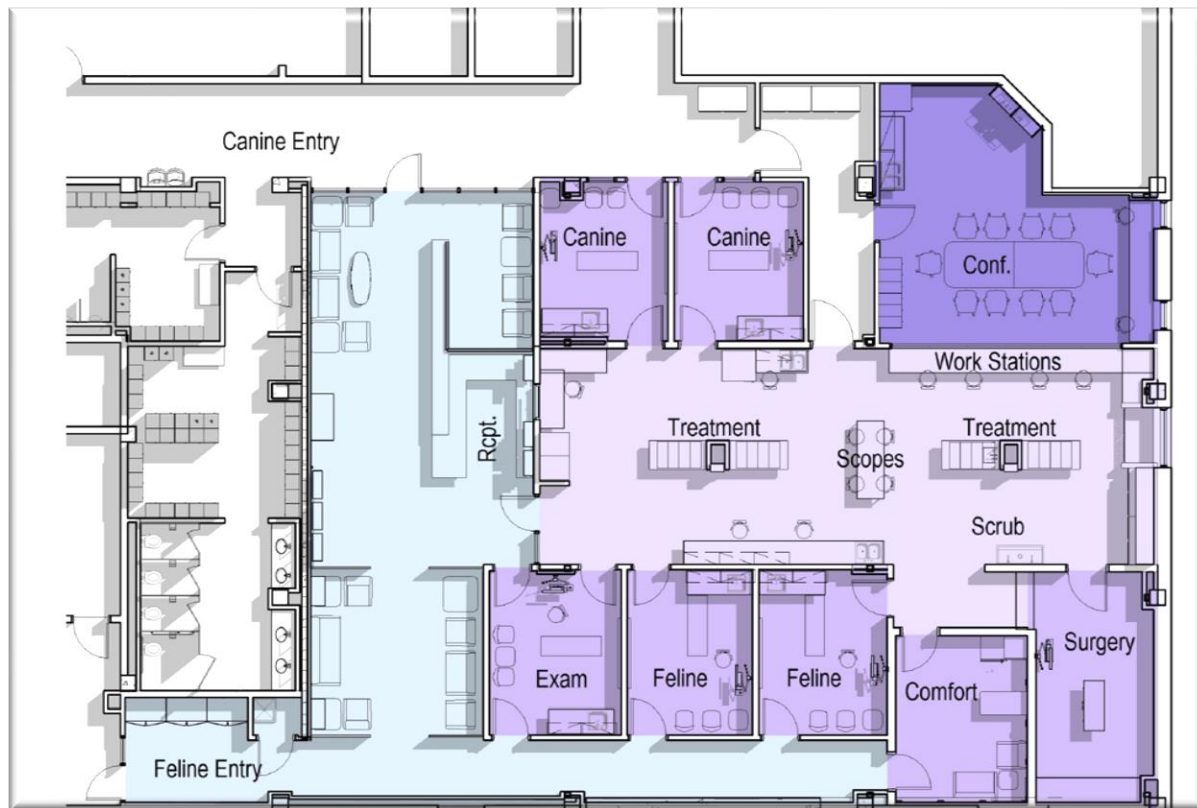

# Current Pet Health Center

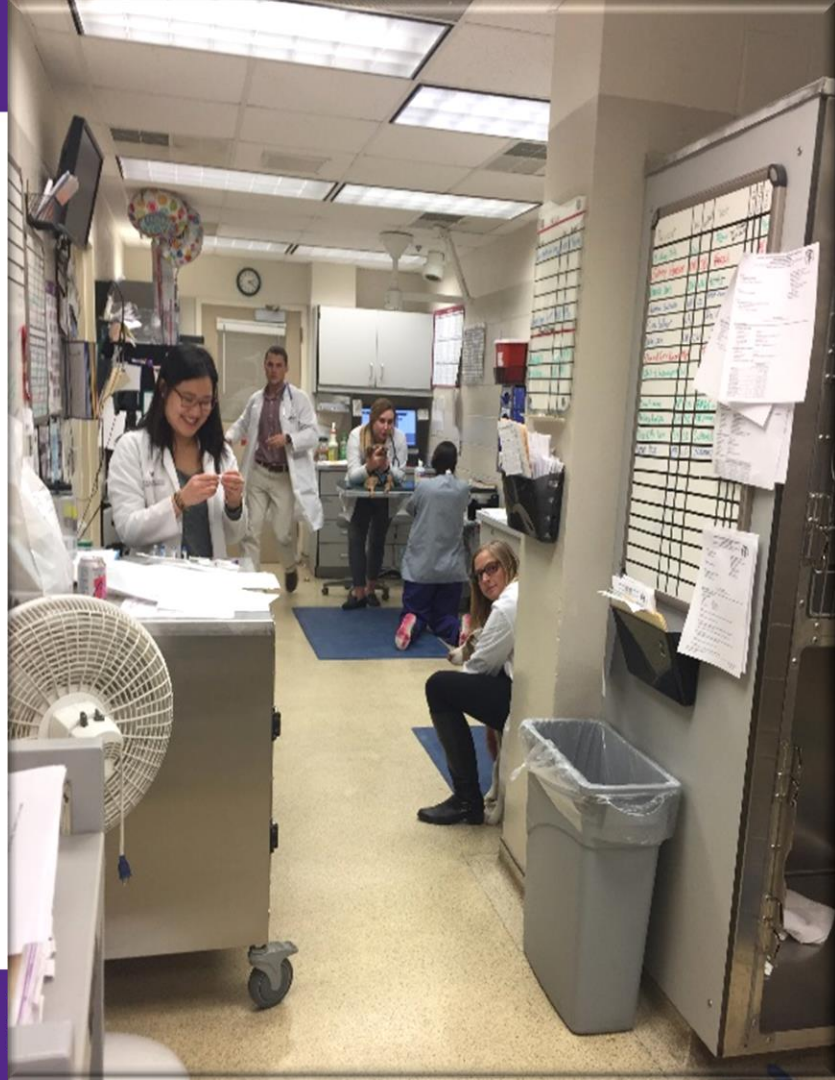



# Frick Auditorium



# Frick post-demolition



New Pet Health Center (Primary Care) Est Completion date – January, 2021





# Waiting Area - canine







# Waiting Area - feline





## Feline hallway



# Treatment Area



# Treatment Area



Treatment Area  
looking into  
Conference  
room



# Surgery Suite



# Exam Room



# Comfort Room



# Equine Performance Testing Center

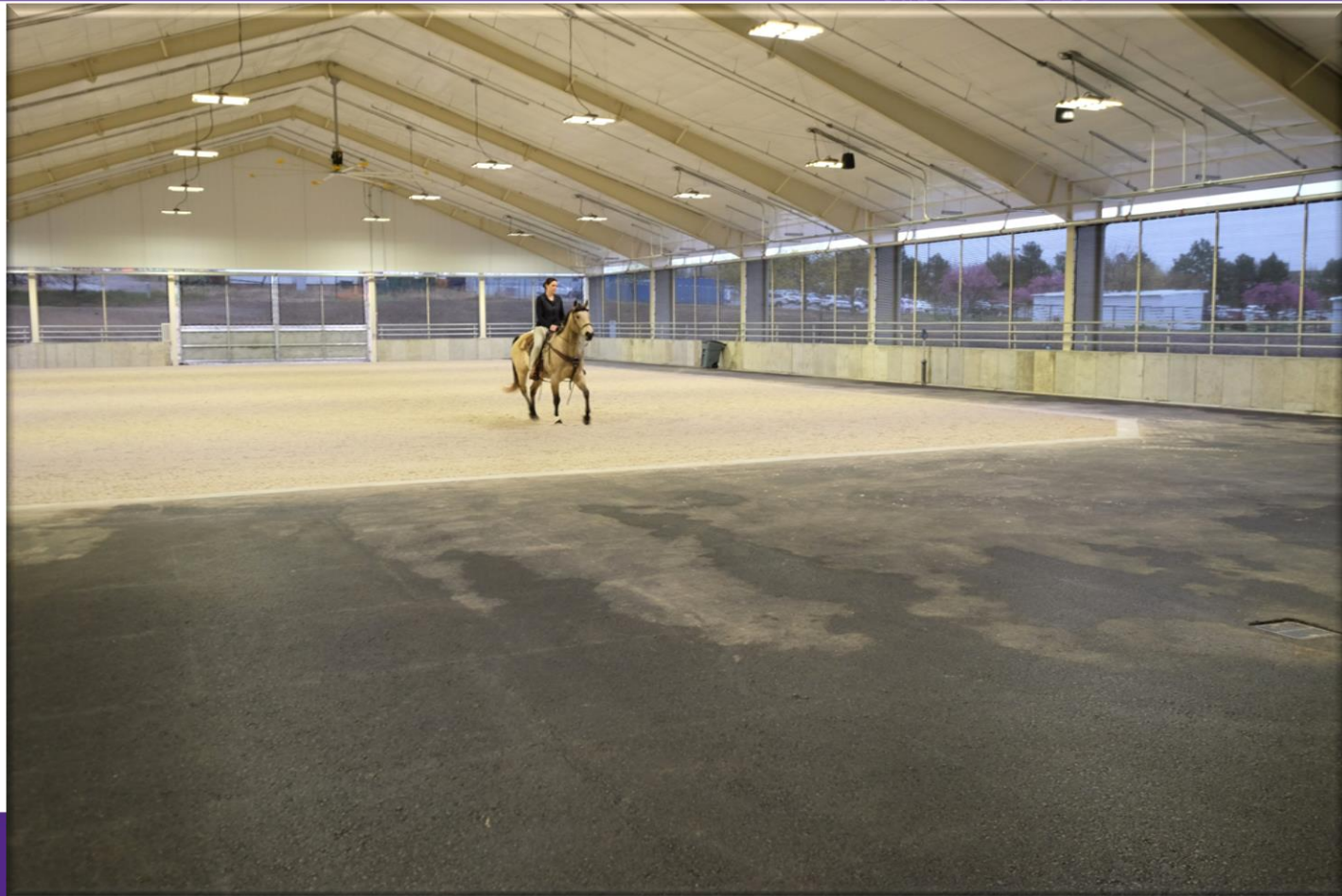



Enclosed

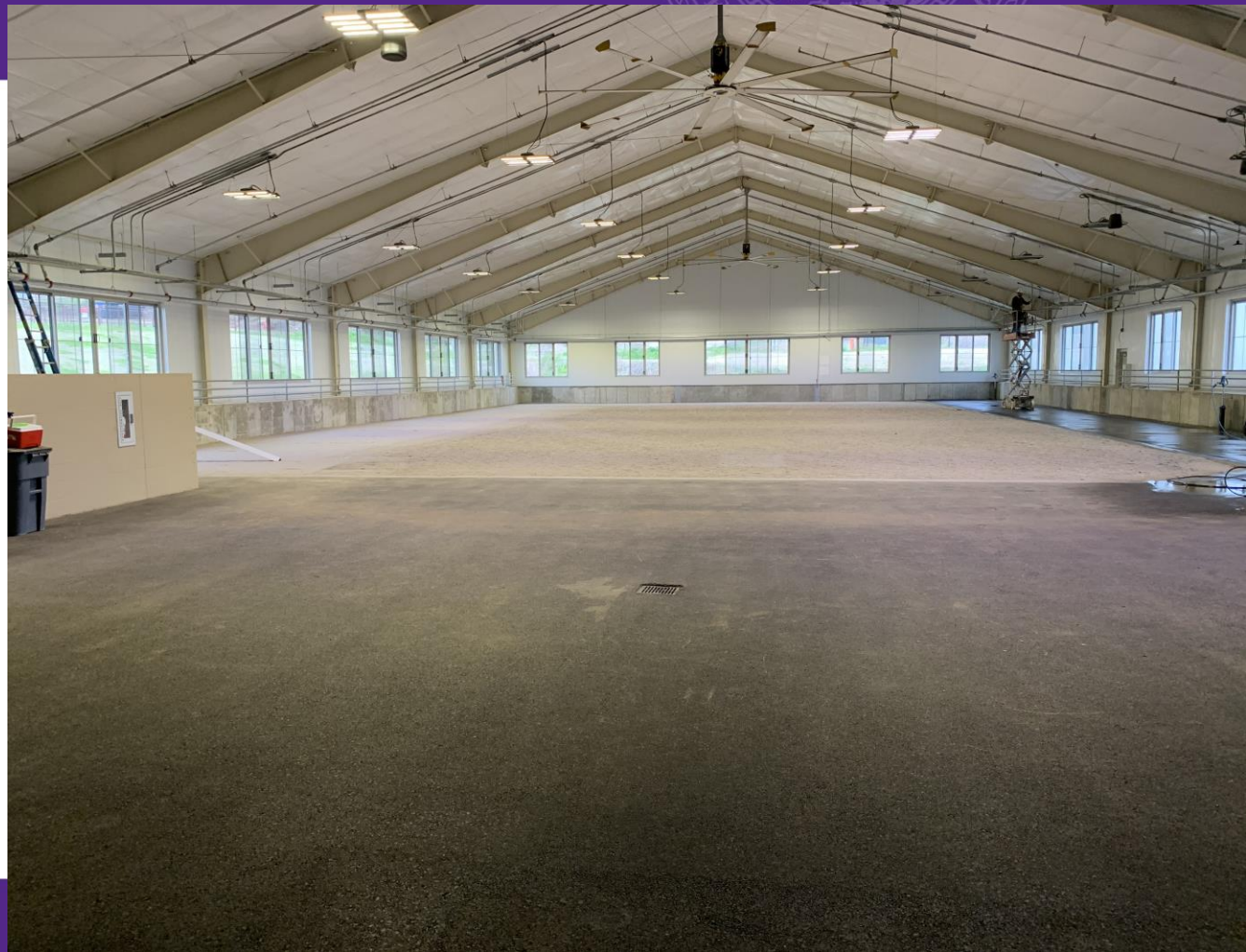

# Shelter Medicine - 25,000 Cases



# New Vehicle: Design

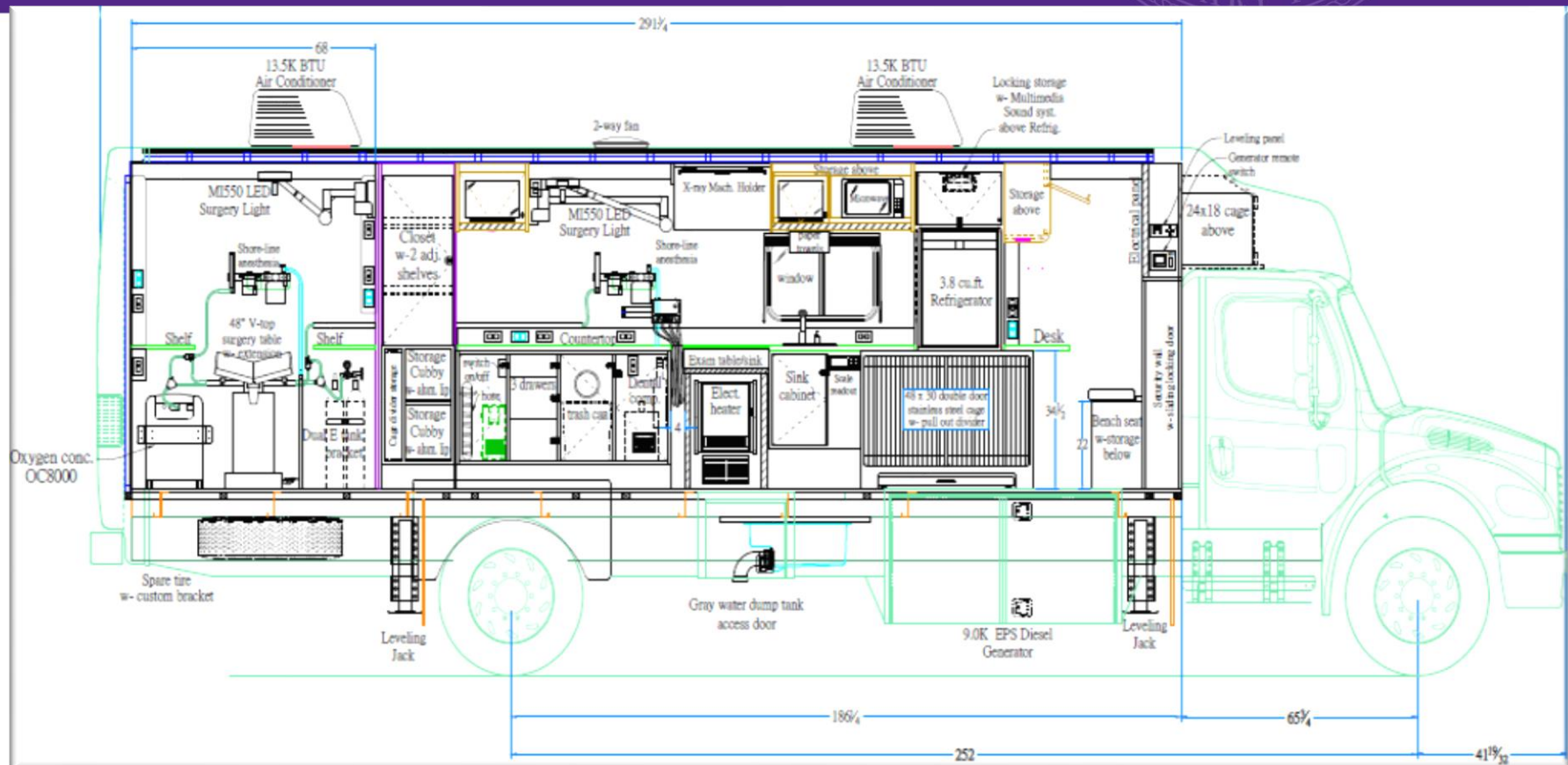

New Vehicle: under construction



New Vehicle: \$450K gifted



# Professional Education - Recruitment

- Director of Admissions and CVM Recruiter
  - 2019: 1012 applicants, 476 interviews, 124 admitted
  - 2020: 1340 applicants, 445 interviews, admissions pending
- Vet Med Recruitment, Outreach, Club of Kansas State (ROCKS)
  - Virtual camp, school visits, club visits, research and extension
- This is How we Role
  - Boys and Girls Club of Manhattan
- Host Pre-Vet Symposium - 2022



# Diversity and Inclusion

**Established Dr. Walter C. Bowie Scholarship Fund**

**Admissions Reform: Diversity statement, resilience statement, no GRE**

**Submitted first HEED application for CVM**

**Instituted Monthly Intercultural Lunch and Learn**

**Diversity and Resiliency Institute of El Paso: Anti-Racism Training (6 hrs)  
- 40 faculty, staff, students received certificate.**

**Rost, Hoffman. “Summer Program for Aspiring Rural Kansas (Spark)  
Veterinarians” USDA NIFA. \$111,000. 9/19-9/21**

**Rost. “Specialized Programs for Recruiting Indigenous, Native and Tribal  
Students” USDA NIFA. \$50,835. 9/21-9/22**



1947 Graduate

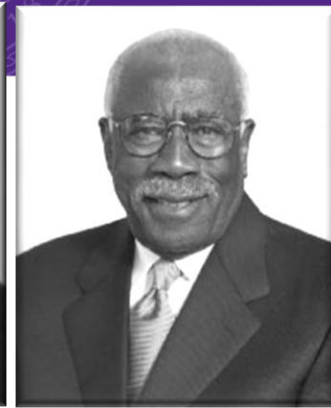

1993 Distinguished Alumni

**Dr. Walter C. Bowie**

# Development

FY '19: Goal \$10,000,000  
\$15,164,871

FY '20: Goal \$12,000,000  
\$11,858,729

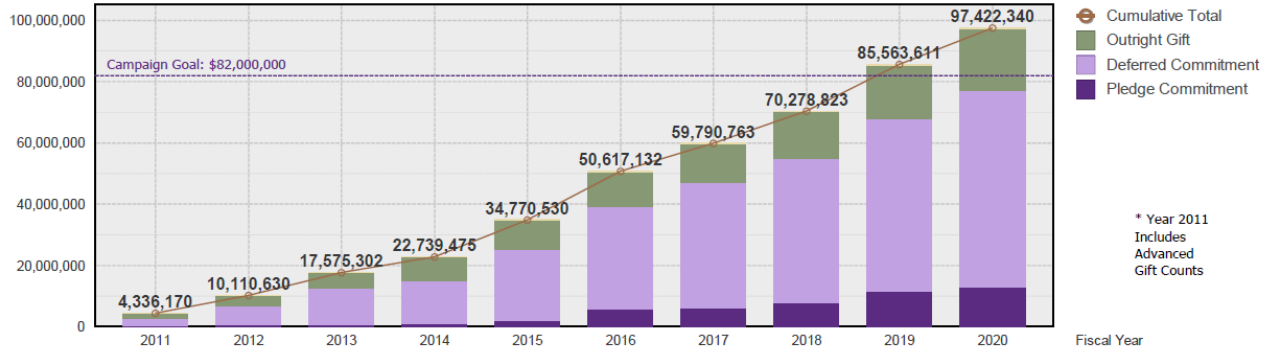

Gift Type	Fund Group	Fiscal Year	2011	2012	2013	2014	2015	2016	2017	2018	2019	2020	Total
Deferred Commitment	Permanently Endowed		\$2,000,000	\$3,025,000	\$3,204,350	\$832,515	\$7,510,198	\$8,778,807	\$3,709,452	\$3,666,380	\$6,740,902	\$6,068,250	\$45,535,854
	Expendable		-	\$250,000	\$2,009,000	\$25,000	\$1,530,000	\$537,500	\$1,025,000	\$1,980,000	\$2,200,000	\$736,110	\$10,292,610
	Term Endowed		\$351,268	\$475,000	\$577,650	\$1,375,000	\$1,007,000	\$781,000	\$2,705,000	\$480,000	\$545,733	\$978,500	\$8,376,151
	Total		\$2,351,268	\$3,750,000	\$5,791,000	\$2,232,515	\$9,147,198	\$10,097,307	\$7,439,452	\$6,126,380	\$9,486,635	\$7,782,860	\$64,204,615
Outright Gift	Permanently Endowed		\$394,415	\$496,093	\$367,231	\$544,769	\$484,731	\$555,269	\$256,522	\$582,632	\$551,727	\$713,377	\$4,946,765
	Expendable		\$1,058,418	\$976,522	\$947,752	\$928,345	\$1,126,496	\$766,925	\$821,261	\$1,576,610	\$1,437,644	\$1,360,414	\$11,000,388
	Term Endowed		\$215,594	\$342,705	\$316,039	\$1,121,795	\$267,759	\$647,437	\$241,045	\$341,488	\$222,282	\$439,578	\$4,155,722
	Total		\$1,668,427	\$1,815,320	\$1,631,022	\$2,594,909	\$1,878,987	\$1,969,631	\$1,318,828	\$2,500,731	\$2,211,652	\$2,513,369	\$20,102,875
Pledge Commitment	Permanently Endowed		-	-	-	\$10,000	\$50,000	\$150,260	\$40,000	\$527,500	\$260,400	\$340,000	\$1,378,160
	Expendable		\$249,110	\$196,875	\$41,400	\$38,000	\$953,620	\$3,628,180	\$285,230	\$1,330,450	\$3,226,100	\$1,192,500	\$11,141,465
	Term Endowed		-	\$15	-	\$287,500	-	\$1,225	\$120	\$3,000	\$100,000	\$30,000	\$421,860
	Total		\$249,110	\$196,890	\$41,400	\$335,500	\$1,003,620	\$3,779,665	\$325,350	\$1,860,950	\$3,586,500	\$1,562,500	\$12,941,485
Deferred Payment	Permanently Endowed		-	-	-	-	-	-	\$90,000	-	-	-	\$90,000
	Expendable		\$10,000	-	-	-	-	-	-	-	-	-	\$10,000
	Total		\$10,000	-	-	-	-	-	\$90,000	-	-	-	\$100,000
Pledge Payment	Expendable		\$57,353	\$12,250	\$1,250	\$1,250	\$1,250	-	-	-	-	-	\$73,353
	Term Endowed		\$13	-	-	-	-	-	-	-	-	-	\$13
	Total		\$57,365	\$12,250	\$1,250	\$1,250	\$1,250	-	-	-	-	-	\$73,365
Total	Total		\$4,336,170	\$5,774,460	\$7,464,672	\$5,164,174	\$12,031,054	\$15,846,603	\$9,173,630	\$10,488,061	\$15,284,787	\$11,858,729	\$97,422,340

2017 to 2020 Endowment:

CVM: 30.2M to \$36.8M

Scholarship: \$13.8M to \$18.1M



# Student Support

- **Scholarship Distribution:** \$1,395,493 '17/18  
\$1,444,323 '18/'19  
\$1,449,696 '19/'20
- **Reduced hidden costs - \$3,300**
- **Classes of 2022/23/24: 51 Kansans (up from 45)**
- **Classes of 2023/24: Class size increase + 5**
- **Tuition Freeze: four consecutive academic years**
- **Mean debt to income ratio: 1.8 (NA – 1.8)**
  - **2018 DIR: 2.2**





- Senior students – Clinical training maintained since May 26<sup>th</sup>
- Years 1-3 – face-to-face laboratories/blended lectures
- Student clubs and outreach activities maintained
- Virtual commencement and white coat ceremony
- CE and development activities expanded, delivered virtually
- Full-service teaching hospital
- Full-service diagnostic laboratory
  - COVID Testing – 200 to 350 samples/day
- MPH students support COVID-19 traceback
- Research Activity: 12 awards, \$6.98M, 3 licensing agreements

# Goals

2020

- Renovation: Auditorium\*, Livestock Services\*, Primary Care Center\*
- Enclose Equine Performance Testing Center\*
- Non-thesis MS degree\*
- Community Outreach/Disaster Response Vehicle\*

2021-2023

- CVM Curriculum Review
- Certificate Programs – FA\*, Shelter\*, Exotics, Business, Sustainability
- On-line MPH: Infectious Disease/Zoonoses\*
- Student AVMA Symposium (\*21)
- Veterinary Educators Colloquium (\*21)
- National Pre-Vet Symposium (\*22)
- Core Research Suite
- Trotter Second Floor Teaching Laboratory

2024-2025

- Surgery suite renovation
- Oncology treatment area
- VDL Building





*Exceptional teaching.*

*Impactful research.*

*Outstanding service.*

*Extraordinary graduates.*



## **1. Research, Scholarly and Creative Activities, and Discovery**

Create a culture of excellence that results in flourishing, sustainable, and widely recognized research, scholarly and creative activities, and discovery in a variety of disciplines and endeavors that benefit society as a whole.

## **2. Undergraduate Educational Experience**

Build a connected, diverse, empowered, engaged, participatory culture of learning and excellence that promotes undergraduate student success and prepares students for their professional, community, social, and personal lives.

## **3. Graduate Scholarly Experience**

Advance a culture of excellence that attracts highly talented, diverse graduate students and produces graduates recognized as outstanding in their respective professions.

## **4. Engagement, Extension, Outreach, and Service**

Be a national leader and model for a re-invented and transformed public research land-grant university integrating research, education, and engagement.

## **5. Faculty and Staff**

Foster a work environment that encourages creativity, excellence, and high morale in faculty and staff, responds to changing needs, embraces diversity, values communication and collaboration, and is respectful, trusting, fair, and collegial for all.

## **6. Facilities and Infrastructure**

Provide facilities and infrastructure that meet our evolving needs at a competitive level with our benchmark institutions and are an asset to recruit and retain quality students, faculty, researchers, and staff.

## **7. Athletics**

Strengthen the interconnectivity between intercollegiate athletics and the campus community to prepare our student-athletes for success in school, in sport, and after graduation and benefit our university, community, and state.